



PRODUCT DESCRIPTION:

Being one of the major suppliers of temporary roof and staging systems, Prolyte products are often used in combination with Scaffolding systems. To facilitate the work of our users when building a stage, Prolyte has developed a system to integrate roof system towers and base sections in a Layher stage floor. By integrating and interconnecting these two systems you can create a safe and secure stage system.

ADVANTAGES:

- Significant ballast reduction; the self weight of the stage can be subtracted (when the stage is sufficiently braced)
- Lateral forces through guy-wiring or wind on the tower sections are absorbed by the substructure
- Clean and even building area for the roof system

- Towers are all built on the same height
 - No need to invest in standard base sections
 - 100% flexible in x/y direction
- Prolyte has created a fully flexible and x/y axis adjustable base system, to take into account that the number of combinations between tower position, stage floor height and position compared to the side of the stage floor are endless.

The size and strength of the components derives from a maximum load structural analysis for the standard LT and ST roof systems. The beams are fitted with a special non-friction based sliding system to allow horizontal forces as well as vertical forces. The frames are utilised to hold cross beams to accommodate additional ballast. All steel frames are delivered with black powder coating.

MORE INFORMATION ON REQUEST



Photo: Metro Productions LTD New Zealand. Project: King Kong premiere in Wellington.

EASYRAIL

System Description:

Handrails and other accessories from the EasyRail range can easily be attached to the decks by inserting a spigot in a pre-bolted hole on each corner of the deck. This makes it possible to assemble the rails after the decks are built, as they are fully independent of the sides or the

underlying constructions of the stage. For the basic line decks, StageDex has developed special adapters for the spigots, which slide into the side profiles of the decks. The EasyRail comes in two different versions, both in compliance with the applicable standards (DIN 15921).



EasyRail mounted on top line deck.

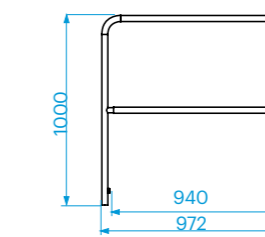

EasyRail railing. SM-RAIL-L100.

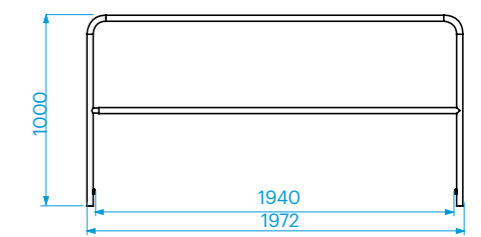

EasyRail railing. SM-RAIL-L200.



EasyRail mounted on basic line deck.

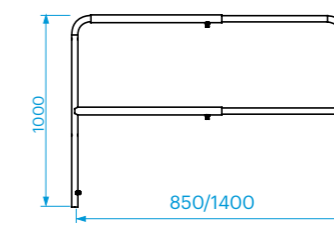

EasyRail railing. SM-RAIL-L85/140.

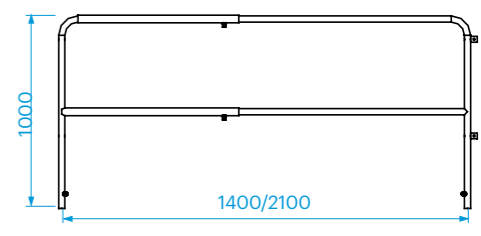

EasyRail railing. SM-RAIL-L140/210.

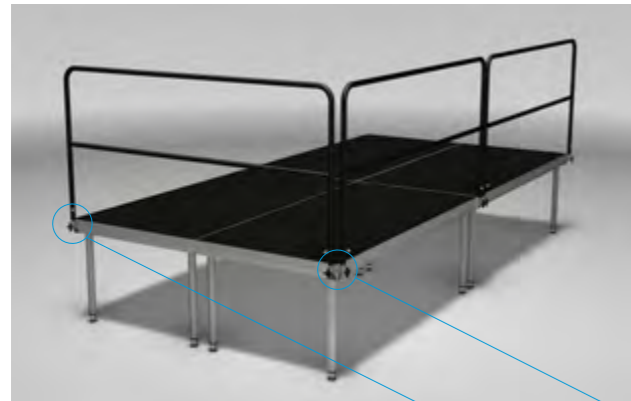

EASYRAIL 30 KG/M
The light-duty version of the EasyRail can resist a horizontal loading of 30 to 60 kg/m. This railing type can be used for stages or areas with no public access. This is the case for most commonly used stages. For top line decks, the railing can be easily mounted on top of the decks by simply bolting a 26 mm spigot to the pre-drilled hole. The railing is available in a fixed and an adjustable type.

FIXED RAIL
SM-RAIL-L100, length 1000 mm.
SM-RAIL-L200, length 2000 mm.

ADJUSTABLE RAIL
SM-RAIL-L85/140, adjustable from 850 to 1400 mm.
SM-RAIL-L140/210, adjustable from 1400 to 2100 mm.

EASYRAIL 30 KG/M - BASIC LINE DECK

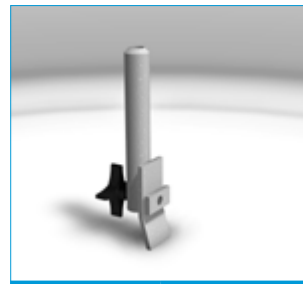

Description: Spigot for handrailing
Code: SM-RAIL-ATT-04

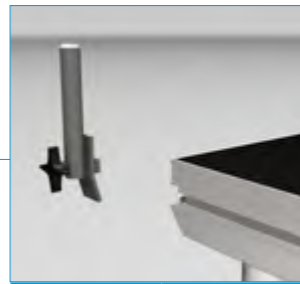

Description: Spigot for handrailing
Code: SM-RAIL-ATT-04

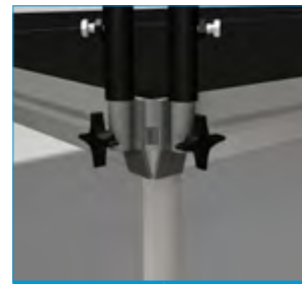

Description: Spigot for handrailing
Code: SM-RAIL-ATT-04

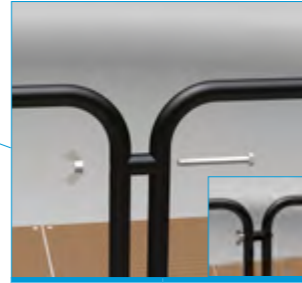
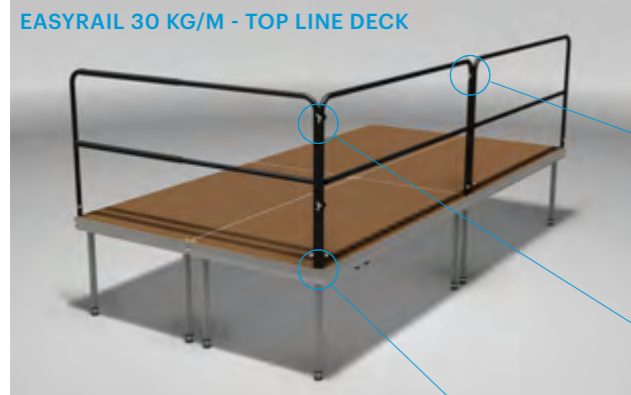

Description: Railing connector
Code: SM-RAIL-CON



Description: Spigot for handrailing
Code: SM-RAIL-ATT-01

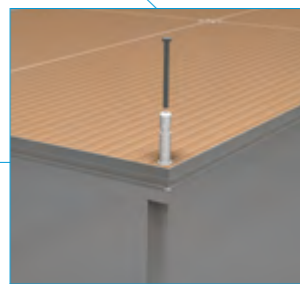

Description: Spigot for handrailing
Code: SM-RAIL-ATT-01
Bolt M12x150
Code: BM-M12x150

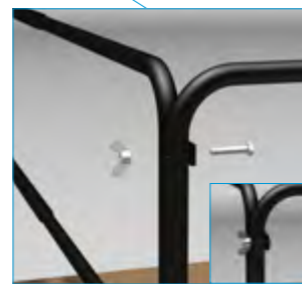

Description: Bolt M10x55
Code: BM-M10x55
M-10 Wingnut
Code: BM-M10WNU
M-10 Spring-wash
Code: BM-M10-SW

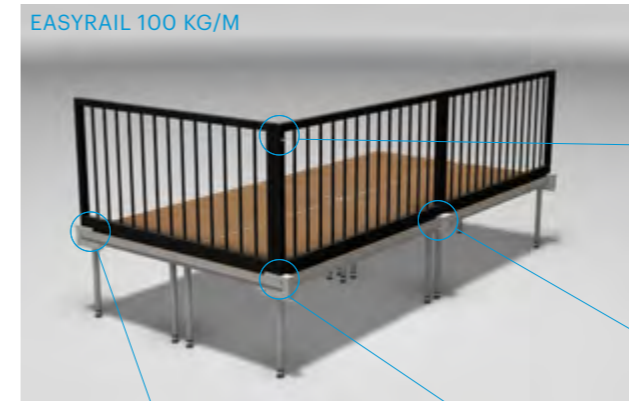

Description: Spigot attachment
Code: SM-RAIL-ATT-08
SM-RAIL-ATT-08-01
For Easy-Frame B
Code: SM-RAIL-ATT-03
For Easy-Frame C
Code: SM-RAIL-ATT-06

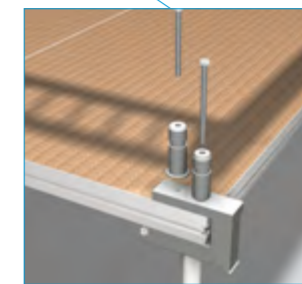

Description: Spigot for handrailing
Code: SM-RAIL-ATT-02
1x Bolt
Code: BM-M12x140
1x Bolt
Code: BM-M12x180

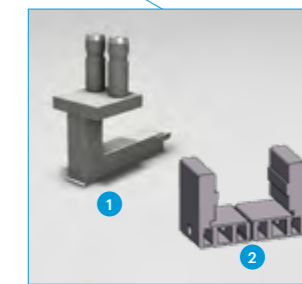

Description: Spigot attachment
Code: SM-RAIL-ATT-09
SM-ACC-CLP-06
For Easy-Frame B
Code: SM-RAIL-ATT-05
For Easy-Frame C
Code: SM-RAIL-ATT-07

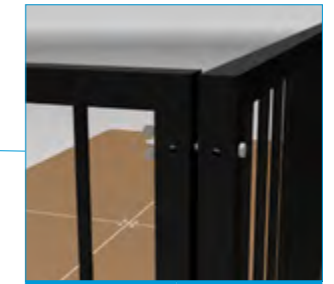

Description: Bolts
Code: BOLT M10X130
Nuts
Code: M10 WINGNUT + WASHER

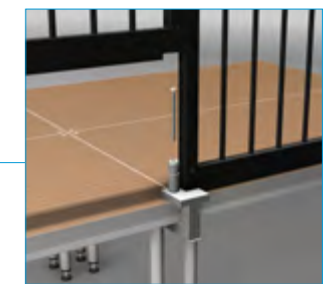

Description: 2x Bolt
Code: BM-M12x180

EASYRAIL 100 KG/M
The heavy-duty version of EasyRail can resist a horizontal loading of 100 to 200 kg/m. This railing type can be used in all circumstances, including portions of the staging with public access, as the railing is in compliance with the applicable regulations. The railing can be easily mounted on top of the decks by simply bolting a 40 mm spigot to the pre-drilled hole, and then using the special railing adapter. The railing adaptor has an extra M12 hole drilled in front of the spigot hole. An extra spigot can be bolted in place here to provide a connection for a corner rail. This type of rail can only be used in combination with top line decks.

RAILING LENGTHS

SM-RAIL-H-L100 RAILING 100KG L=100CM
SM-RAIL-H-L200 RAILING 100KG L=200CM

SM-RAIL-H110-L100 RAILING 100KG H=110CM, L=100CM
SM-RAIL-H110-L200 RAILING 100KG H=110CM, L=200CM

CORNER PIECES

SM-RAIL-H-L093C RAIL FOR CORNER 100KG L=93CM
SM-RAIL-H-L193C RAIL FOR CORNER 100KG L=193CM

SM-RAIL-H110-L093C RAIL FOR CORNER 100KG,H=110CM, L=93CM
SM-RAIL-H110-L193C RAIL FOR CORNER 100KG,H=110CM, L=193CM

ACCESSORIES

SM-RAIL-ATT-02 Spigot 40 mm for top line deck
SM-RAIL-ATT-03 Adaptor for 100 kg/m rail for top line deck