



LITEDECK LEG SYSTEM

LiteDeck is designed around a universal leg system constructed from standard 48 mm x 4 mm round section aluminium tubes. All LiteDeck legs are constructed from high grade 6082T6 tubes, and are supplied cut to length.

Code	Description	
LD-L165	Leg 16,5 cm	Stage height 19 cm
LD-L355	Leg 35,5 cm	Stage height 38cm
LD-L545	Leg 54,5 cm	Stage height 57 cm
LD-L735	Leg 73,5 cm	Stage height 76 cm
LD-L925	Leg 92,5 cm	Stage height 95 cm

Shape	Size	Quantity
	8' x 4'	4
	6' x 4'	4
	8' x 2'	4
	2 m x 1 m	4
	4' x 4'	4
	1 m x 1 m	4
	4' x 4'	3
	1 m x 1 m	3
	4' x 4'	3
	1 m x 1 m	3
	4' x 4'	4
	1 m x 1 m	4



STEP SYSTEMS

The LiteDeck Modular Step system is designed specifically to offer the greatest flexibility from the smallest number of standard components. In this way, rental companies, event organisers and production teams can

plan incremental investments in the system, confident that they will be able to offer step configurations to suit every eventuality.



Typical step unit configuration

- 1 Handed top rail
- 2 Handed mid rail
- 3 Handed bottom rail
- 4 Expanding spigot Ø50 mm
- 5 Ø50 mm Infill tube for handrail
- 6 Expanding spigot Ø30 mm
- 7 Ø30 mm Infill tube for handrail
- 8 LD-SUM-1 Modular step
- 9 Leg frame
- 10 Hook on step bracket
- 11 Taperlok connection

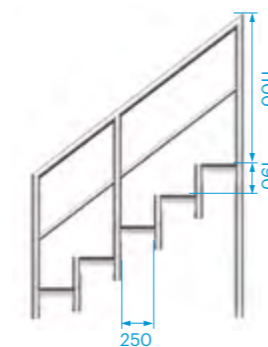
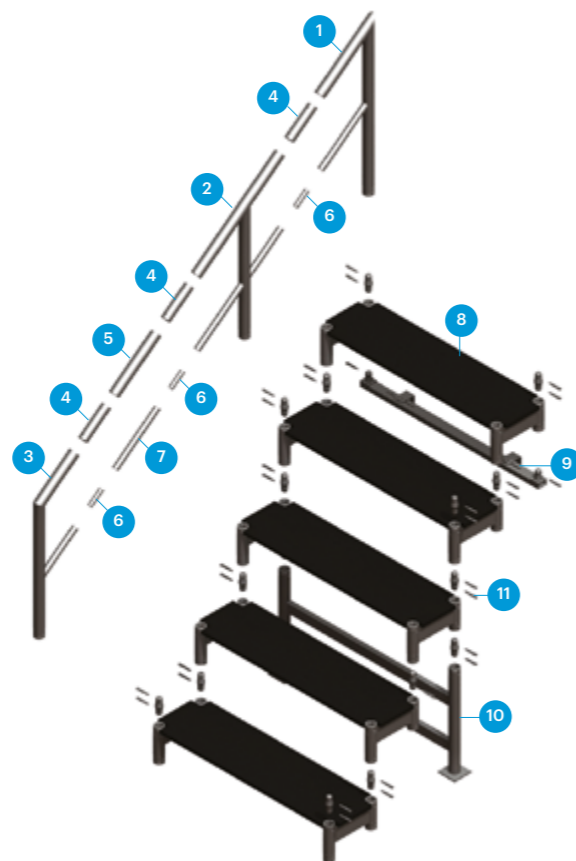

Code	Components	Step Units												
		2 Step	3 Step	4 Step	5 Step	6 Step	7 Step	8 Step	9 Step	10 Step	11 Step	12 Step	13 Step	
LD-MSU	Modular Steps	2	3	4	5	6	7	8	9	10	11	12	13	
LD-MHBL / LD-MHBR	Handed Bottom Rails left / right	2	2	2	2	2	2	2	2	2	2	2	2	
LD-MHML / LD-MHMR	Handed Mid Rails left / right			2	2	2	2	2	2	2	2	2	2	
LD-MHTL / LD-MHTR	Handed Top Rails left / right	2	2	2	2	2	2	2	2	2	2	2	2	
LD-30IF314	314 mm Ø30 mm infill tube for Handrail		2		2	4	2							
LD-30IF628	628 mm Ø30 mm infill tube for Handrail						2	4	2					
LD-30IF942	942 mm Ø30 mm infill tube for Handrail								2	4	2			
LD-30IF1256	1256 mm Ø30 mm infill tube for Handrail										2	4	2	
LD-30IF1570	1570 mm Ø30 mm infill tube for Handrail												2	
50FILL314	314 mm Ø50 mm infill tube for Handrail		2		2	4	2							
50FILL628	628 mm Ø50 mm infill tube for Handrail						2	4	2					
50FILL942	942 mm Ø50 mm infill tube for Handrail								2	4	2			
50FILL1256	1256 mm Ø50 mm infill tube for Handrail										2	4	2	
50FILL1570	1570 mm Ø50 mm infill tube for Handrail												2	
LD-MLF424	Leg Frame 424 mm			1	1	1	1	1	1	1	1	1	1	
LD-MLF994	Leg Frame 994 mm						1	1	1	1	1	1	1	
LD-MHO	Hook On Step Bracket	1	1	1	1	1	1	1	1	1	1	1	1	
SP/AES (2)	Expanding Spigot Ø30 mm	2	4	4	6	8	8	8	8	8	8	8	8	
AO/AES	Expanding Spigot Ø50 mm	2	4	4	6	8	8	8	8	8	8	8	8	
	TaperLok Connection Set*	6	8	14	16	18	22	24	26	30	32	34	38	

Code	LD-SUM2	LD-SUM3	LD-SUM4	LD-SUM5	LD-SUM6	LD-SUM7	LD-SUM8	LD-SUM9	LD-SUM10	LD-SUM11	LD-SUM12	LD-SUM13
Stage Height (mm)	380	570	760	950	1140	1330	1520	1710	1900	2090	2280	2470

* Connection Set consists of: 1 Conical Spigot, 2 Taper Pins and 2 R Clips